

magnet-Subdesk



magnet-Subdesk

Hinged cover with brush built-in the table top / desk. It ensures permanent access to the cable channel.

Due to its modern and simple design, not only **magnet-Subdesk** makes the work environment more comfortable, but also improves aesthetic of the desk.

It's available in two versions: 4M and 6M.

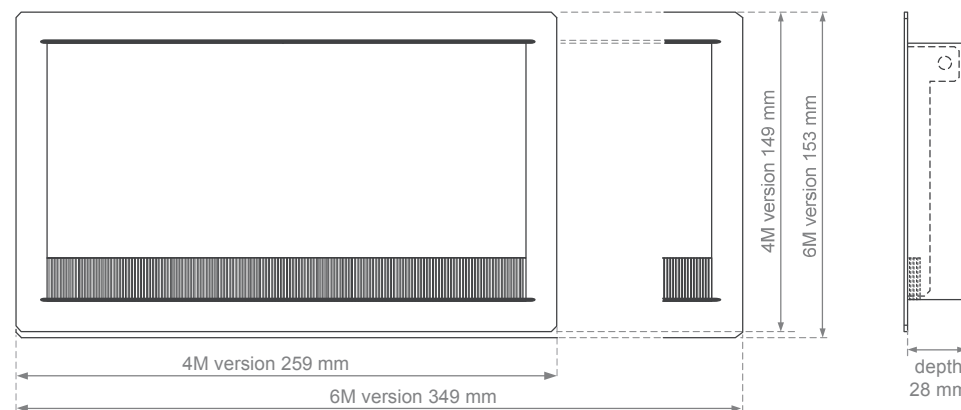
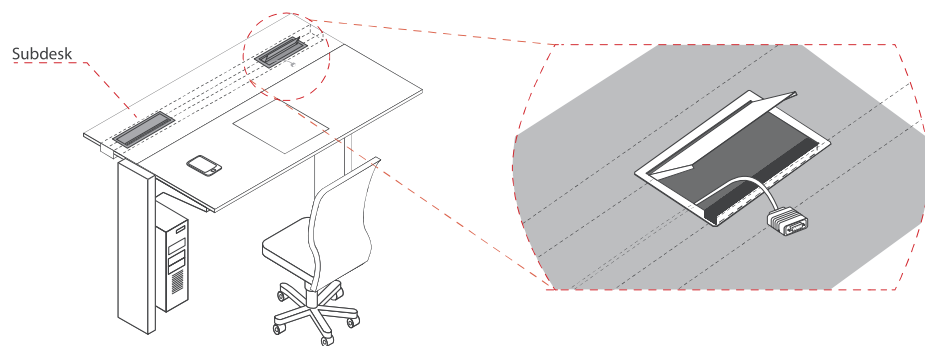

Mounting hole dimensions:

version	a x b
4M	240 mm x 135 mm
6M	326 mm x 135 mm
	+1mm/ -0mm

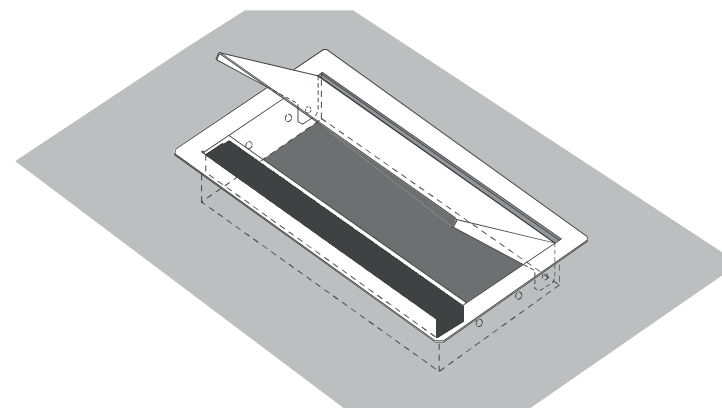
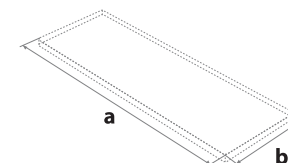

Assembly

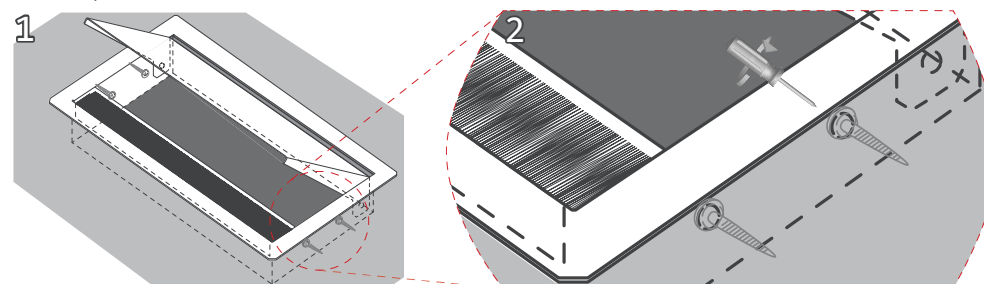

Assembling of **magnet-Subdesk** using 4 wood screws.